



Order No. 4.24173 Baby Elephant



Order No. 4.24175 Lion

**Play value**

Our three artistically designed animal babies, Lion, Elephant and Rhinoceros, create a friendly atmosphere and are instantly accepted by children. Without needing any encouragement at all, they play riding games, pat their faces and pull on their tails.

Play sculptures such as these are particularly well suited to accentuate children's worlds and strengthen the identity of a space. These installations create a welcoming atmosphere for entrance areas to kindergartens, children's hospitals and similar institutions.

**Fundamental characteristics**

- Very special appeal
- Eye-catcher of a play area
- Attractive meeting point
- Incentive for playing: curiosity, role-playing games, experiencing closeness
- Movement: climbing up

**Recommended for**

- Kindergarten children
- Supervised play areas, such as kindergartens, schools, after-school programmes or similar
- Public play areas without supervision, such as playgrounds, parks or similar



Order No. 4.24176 Rhinoceros



Order No. 4.24176 Rhinoceros

**Baby Elephant  
Lion  
Rhinoceros**

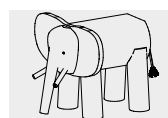

4.24173

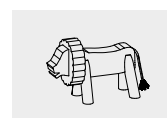

4.24175

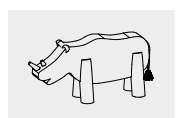

4.24176

**Order No. 4.24173  
Baby Elephant**

Safety distance →  
Device dimensions ●  
Functional distance —

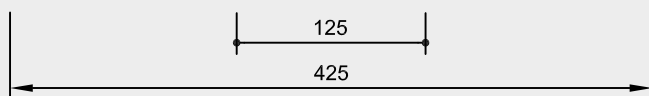
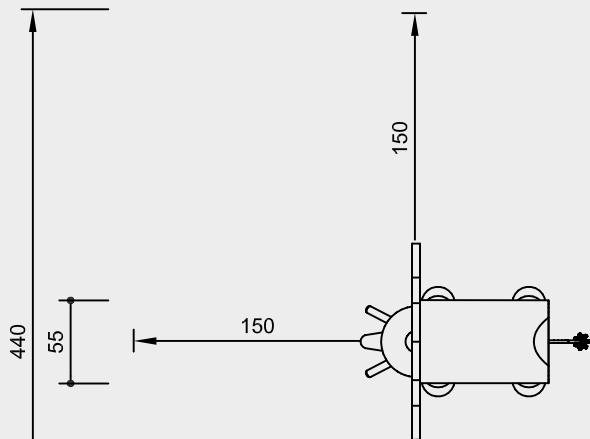

**Order No. 4.24175  
Lion**

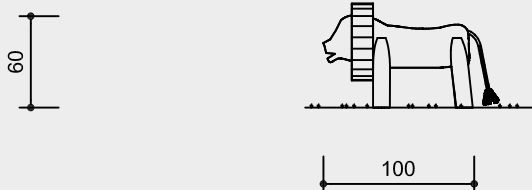

**Order No. 4.24176  
Rhinoceros**

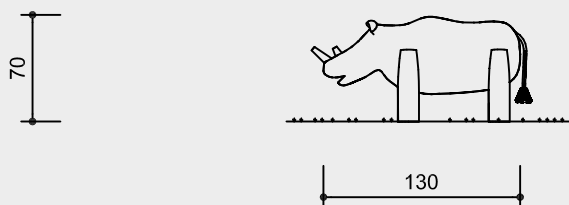

Scale 1:50

Safety check according to DIN EN 1176

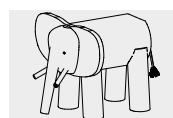

4.24173

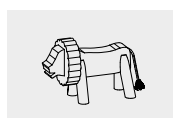

4.24175

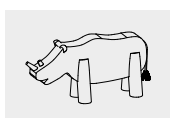

4.24176

**Technical information**

Equipment made of mountain larch

**Peeled white**

Palisades peeled white means that bark, cambium and sapwood are removed, the natural shape of the trunk is preserved and can be experienced



**Core-free**

Sawn-timbers core-free, thus decreasing occurrences of cracking and undesired changes in shape



**Ground anchor**

All parts used for anchoring to the ground are made of hot-dip galvanised steel or stainless steel



Tail made of PP rope, Ø 16 mm, 3 strands, weather-resistant, standard colour: natural

**Order No. 4.24173 Baby Elephant**  
As above, but in addition with

**Plywood**

Plywood made of mountain larch, three-layer (3 cm) or five-layer (4 cm). High dimensional stability, waterproof, glued according to DIN EN 13353:2011



**For more detailed explanation of the quality characteristics see price list.**

**Dimensions**

(small deviations possible)

**Order No. 4.24173 Baby Elephant**

Height	1.00 m
Length	1.25 m
Width	0.55 m
Weight	200 kg

**Order No. 4.24175 Lion**

Height	0.60 m
Length	1.00 m
Width	0.45 m
Weight	60 kg

**Order No. 4.24176 Rhinoceros**

Height	0.70 m
Length	1.30 m
Width	0.40 m
Weight	100 kg

**Components**

1 Animal and 4 foundation irons each

**Installation information**

Surfacing requirements corresponding to a fall height of ≤ 1.00 m (please refer to price list for more detailed information)

**Foundations**

**Order No. 4.24173 Baby Elephant**

2 items 90 x 30 x 30 cm  
Excavation depth 50 cm

**Order No. 4.24175 Lion**

2 items 80 x 30 x 30 cm  
Excavation depth 50 cm

**Order No. 4.24176 Rhinoceros**

1 item 90 x 60 x 30 cm  
Excavation depth 50 cm

**Attention:**

**Exact measurements may vary; for all installation dimensions refer to current assembly instructions.**

Technical changes reserved.